

# Snowdon/Impress Shower Cubicle

Firstly, fit the shower tray as per manufacturers instructions taking into account the services required behind the cubicle. Please ensure that you cover and protect the shower tray while you are installing the cubicle. Read instructions carefully before you start the installation.



## STEP 1

Measure 15mm from the back of the tray and draw a straight line through it

running parallel with the back edge of the tray.



## STEP 2

Take the back piece of panel fixing extrusion and place on the line previously drawn. Drill and fix the panel fixing extrusion to the back of the tray using the pre-drilled holes in the extrusion. The extrusion will be approximately 100mm short from each side of the tray.

100mm short from each side of the tray.



## STEP 3

**NOTE: Before you go any further you will need to consider the services required behind the cubicle and it may be simpler to start to install the services now.**

Offer the back panel onto the panel fixing extrusion. You will notice that there are stickers in the top hand corners of the back panel indicating left and right. These must be facing inwards towards the tray.



## STEP 4

Measure 15mm from the side of the shower tray and mark a straight line through it running parallel with the side of the tray as you did with the back panel



## STEP 5

Take one of the side pieces of panel fixing extrusion and place on the line previously drawn along the side of the tray, making sure that the holes

in the extrusion are directly over the line on the tray. Drill and fix the panel fixing extrusion to the side of the tray using the pre-drilled holes in the extrusion



## STEP 6

Locate the side panel into the back panel, turn and clip into place as shown in the picture.



## STEP 7

Now that the two panels have clipped together you will need to push the panel down onto the panel fixing extrusion.

If you are installing a Snowdon Cubicle Follow steps 4-5 with other Side Panel



## STEP 8

Insert the corner gasket into back corners of the cubicle where the panels meet.



## STEP 9

If you are installing a roof place the roof onto the cubicle, secure and screw in each corner.



### STEP 10

Put the roof corner caps over the four corners of the roof.



### STEP 11

Insert the rubber gasket into the underside of the roof and also clip the roof capping into the exposed underside of the roof.

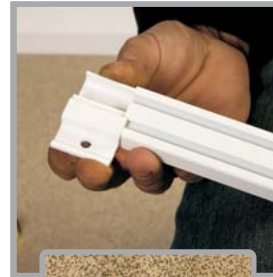

### STEP 12

Slide the two curtain rail hanging brackets onto the curtain rail. Slide the right amount of curtain rail female glides into the bottom track of the rail and put the closing caps onto each end of the rail.



### STEP 13

Offer the assembled curtain rail into place and drill holes to screw the rail to the cubicle. Do this on both sides and screw rail into place.

Offer the assembled curtain rail into place and drill holes to screw the rail to the cubicle. Do this on both sides and screw rail into place.



### STEP 14

Locate the doors into the side channels on the side panels.



### STEP 15

Place the door setters under the doors and push firmly down on the doors.

the doors.

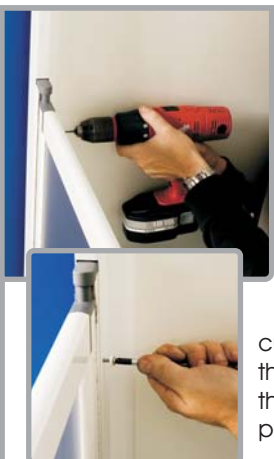

### STEP 16

Once you have the doors in the right position drill through the pre-drilled holes in the door channels on the inside of the cubicle and screw through, securing the doors to the panels.



### STEP 17

Ensure that the tray and cubicle are clean and dry and free of grease and water. Silicone seal along the bottom of the panels making a water tight seal between the tray and the panels.



### STEP 18

Offer the curtain into place. Put the curtain eyelets over the female curtain glides in the rail then clip

the male curtain glides over the top. The installation is now complete.