

Shower Door

Installation

Instructions



Door system

Table of contents

Page	Description & Reference
3 & 4	Fitting Kits Supplied With Doors & Panels
5 & 6	Panel Fitting: Reference A&B
7 & 8	Door Fitting: Reference EFG&H
9 & 10	Floor To Ceiling Pole Fitted: Reference C&D

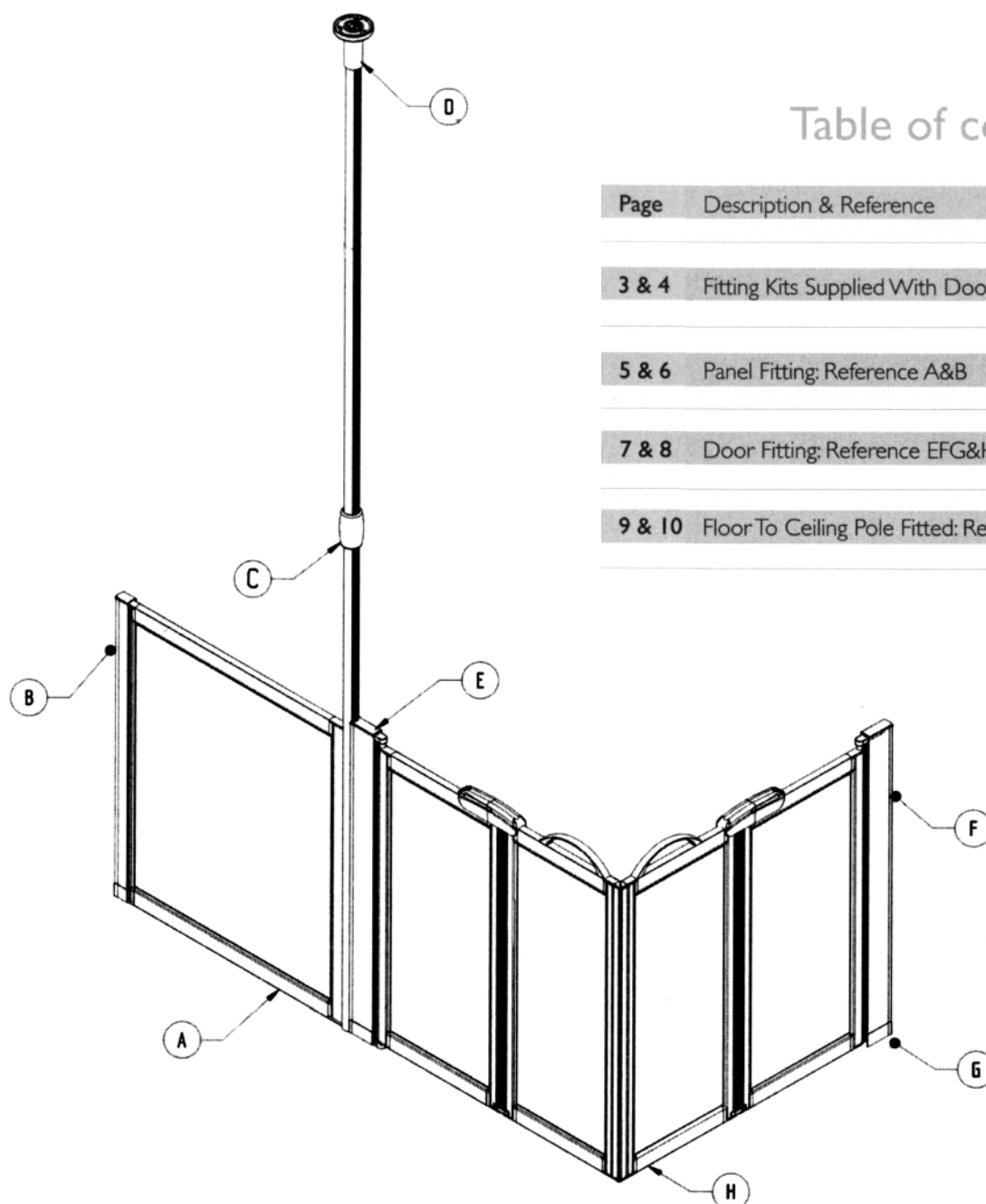

Every effort has been taken to ensure that this product reaches you in good condition. If damaged, please report to your supplier immediately.

This door system has been designed and manufactured in the UK, to very high standards, if fitted and used correctly it should provide years of trouble free use.

It is important that you take a minute to read this fitting guide. It will enable you to correctly install this product.

Please note, this is a generic guide which covers all of the configurations which make up the Standard Hinge, Rise Slider & Air Assisted Rise Slider range of products.

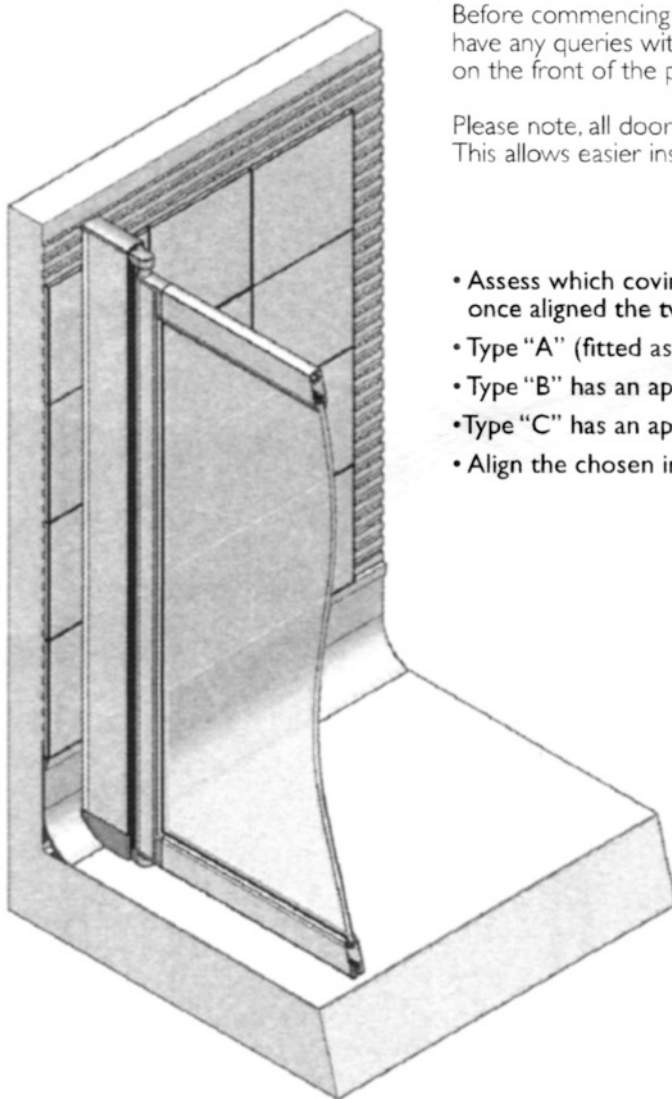

Before commencing installation please cover and protect your shower tray. If you have any queries with regards to the doors please quote the order number shown on the front of the packaging.

Please note, all doors are fitted as standard with a coving profile moulding. This allows easier installation when doors are fitted on wet floors.

- Assess which coving insert suits your application best. This is important, as once aligned the two mouldings are fixed
- Type "A" (fitted as standard) has an approximate 50mm radius
- Type "B" has an approximate 35mm radius
- Type "C" has an approximate 5mm radius
- Align the chosen insert with the main moulding body and slide/press together.

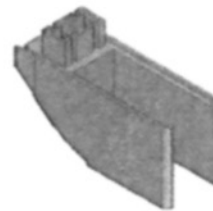

Type "A" Insert fitted as STD

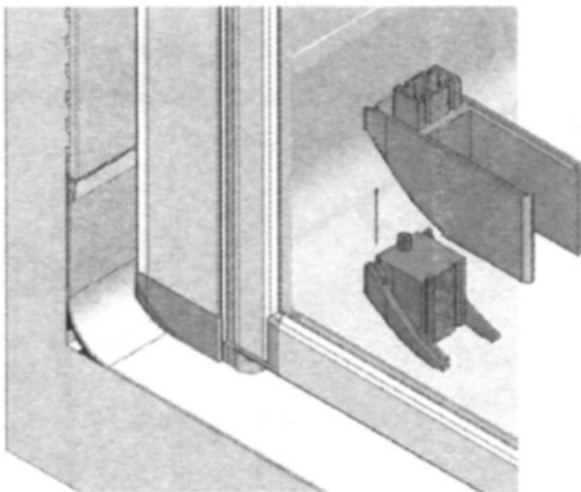

Type "B" Insert

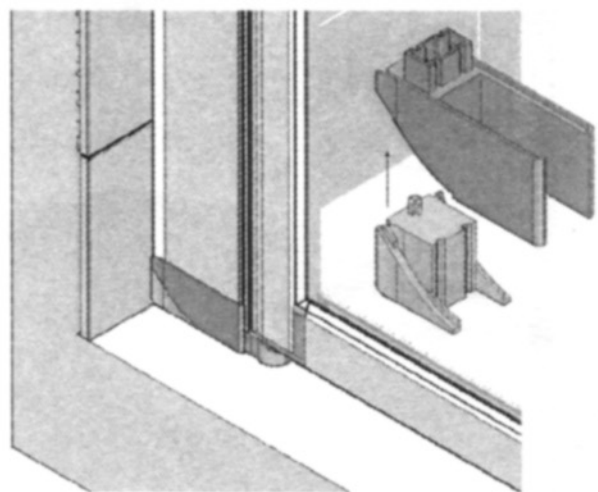

Type "C" Insert

Fitting Kit Type A



3mm Drill Bit

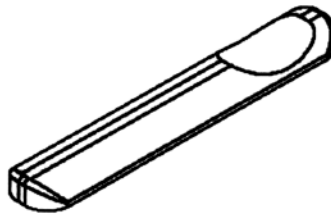

Door Packers x 2

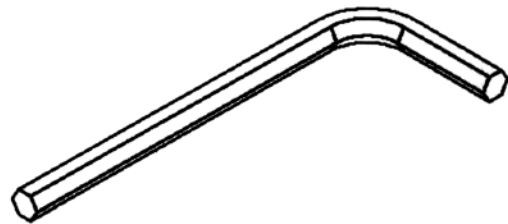

Allen Key x 1



Plastic Plugs x 4



Plastic Collar & Domed
cover cap x 4



8swg x 2.5 inch Pozi Csk
Woodscrews x 4



8swg x 1/2 inch Pozi Pan
Self Tapping x 4

Fitting Kit Type B



3mm Drill Bit

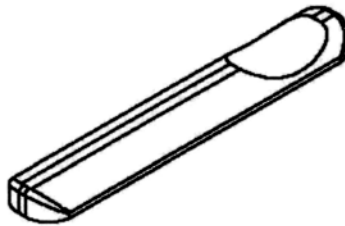

Door Packers x 2

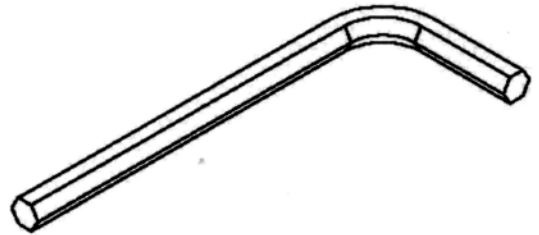

Allen Key x 1



8swg x 2.5 inch Pozi Csk
Woodscrews x 4



Plastic Plugs x 2



Plastic Collar & Domed
cover cap x 2



1 x Panel fixing Extrusion



8 swg x 1 1/2 Pozi Pan
SelfTapping Screw x 2
(Pole block)



Floor to ceiling pole
fixing block x 2



6 swg x 3/4 Pozi Pan
SelfTapper x 4
(panel fixing extrusion)



8 swg x 1/2 Pozi Pan
SelfTapping Screw x 12
(door locking screws)

Fixed Panel

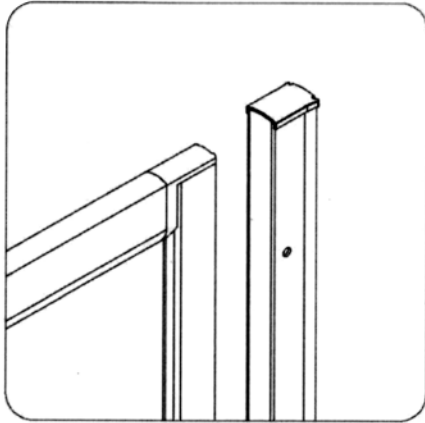

Having decided on the correct position for the panel mark the position on the wall. Remove the panel from the wall fixing channel.

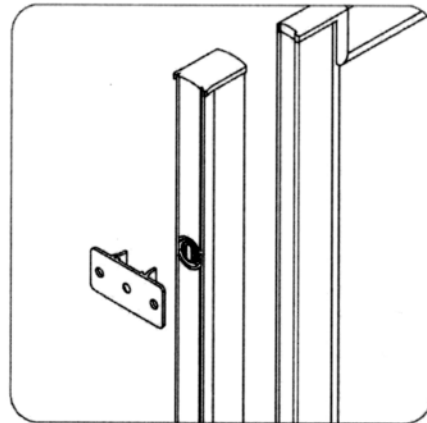

Clip the 2 plastic locating plates in place ensuring that they are correctly seated.

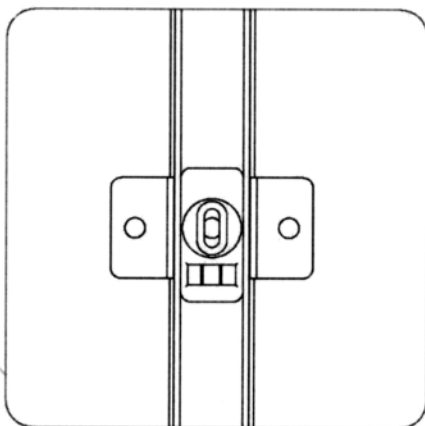

Align the spirit level bubble

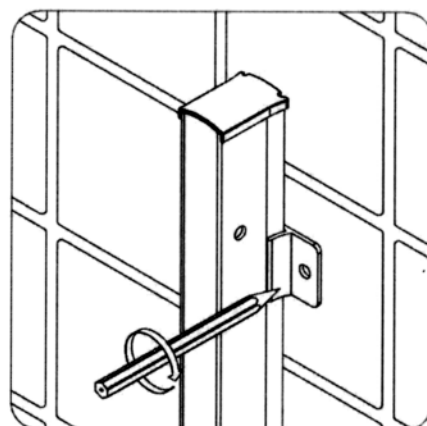

Mark the 2 alignment points, repeat for the lower fixing (**MUST NOT BE DRILLED**)

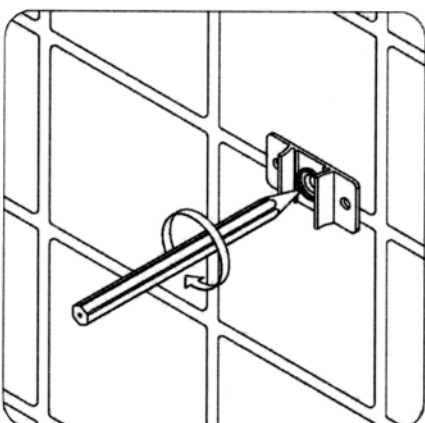

Unclip the marking plate and align with 2 points and mark the centre hole for drilling (**do not drill the outer marked point**)

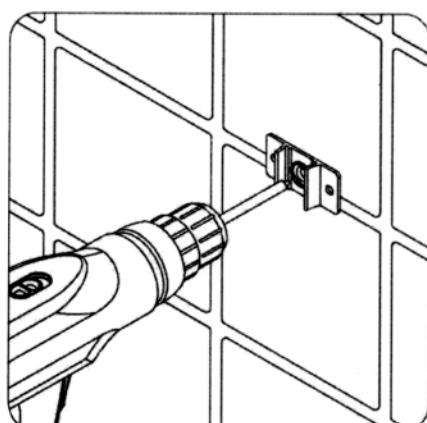

Using a suitable drill bit, **drill the marked centre hole only.**

Fixed Panel

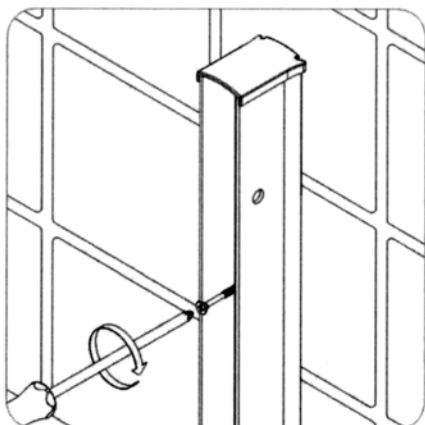

Using appropriate fixings screw the panel channel to the wall ensuring that the spirit level bubble is central.

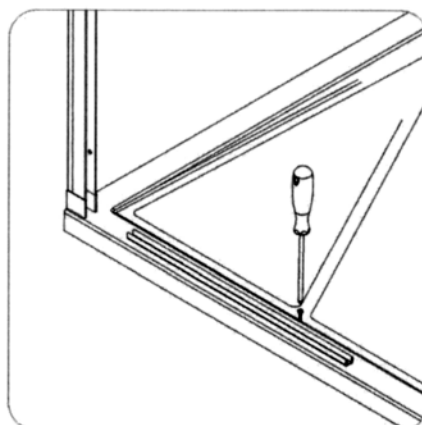

Project a pencil line from the centre of the wall channel. Place the plastic extrusion approximately half way along the panel length and mark the holes positions.

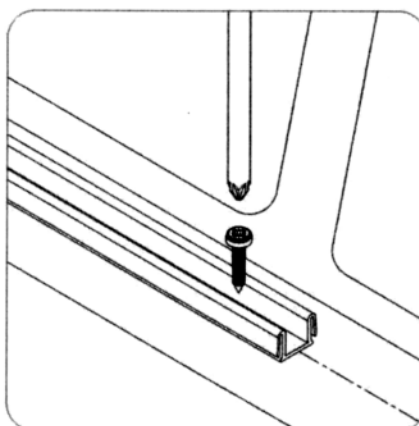

Drill and screw the panel fixing extrusion to the tray.

Caution: Once clipped down the panel cannot be removed.

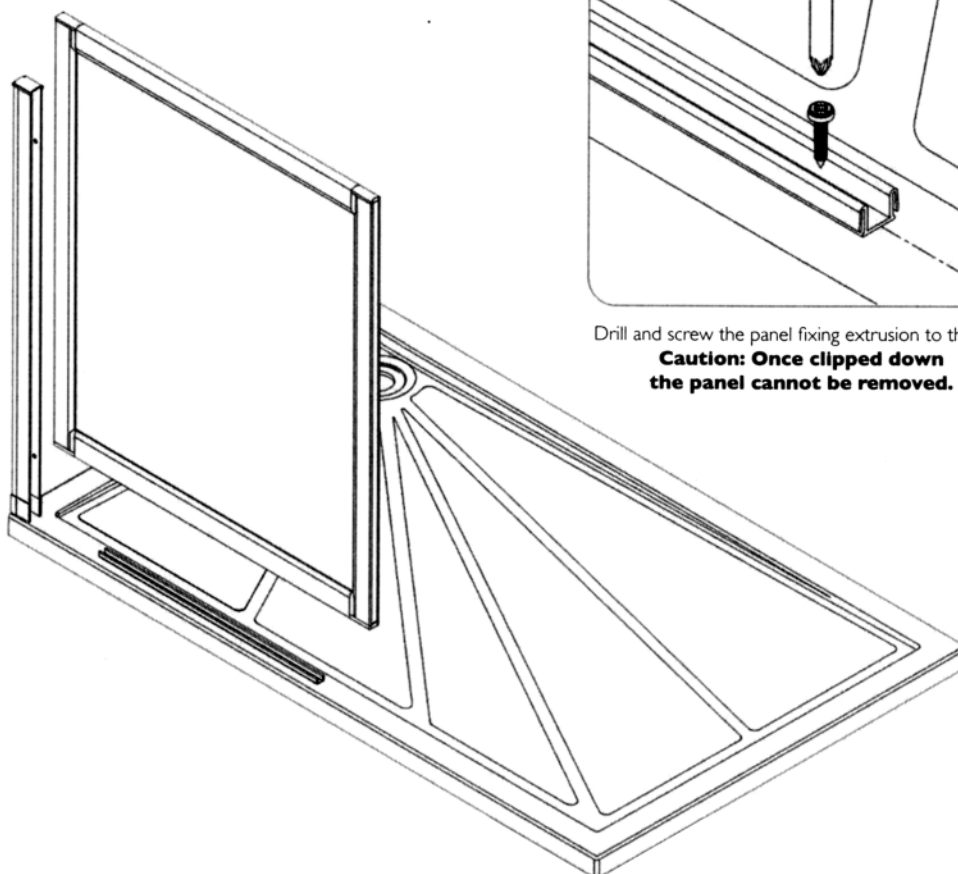

Doors

Prior to installation the doors should be placed on the tray or wet floor area to ensure that they are a correct fit. Doors should be positioned so that bottom seals allow water to run back into the tray.

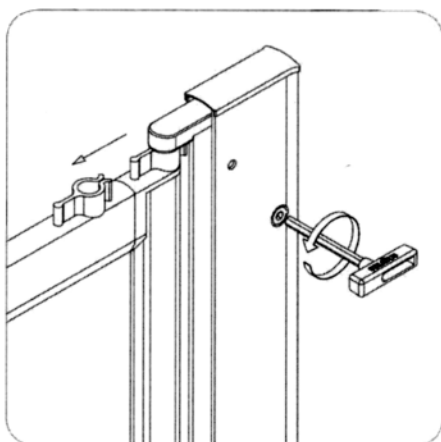

Using the allen key provided release the 2 allen screws & remove the compensator channel.

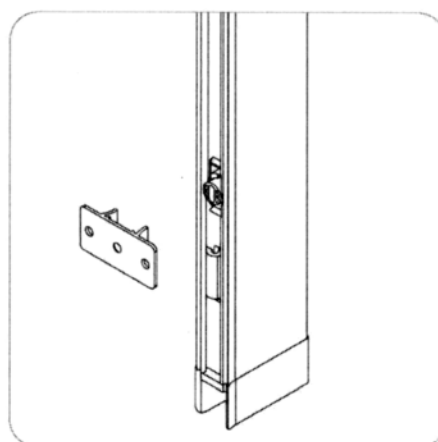

Clip the 2 plastic locating plates in place ensuring that they are correctly seated.

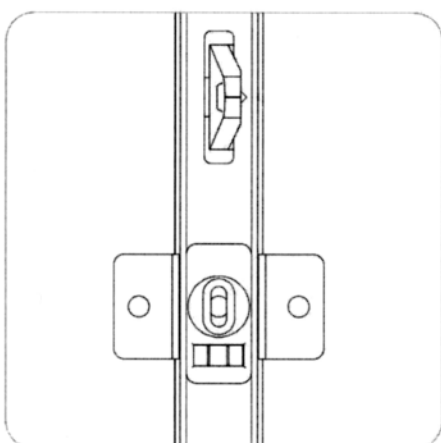

Align the spirit level bubble.



Mark the 2 alignment points, repeat for the lower fixing
(MUST NOT BE DRILLED)

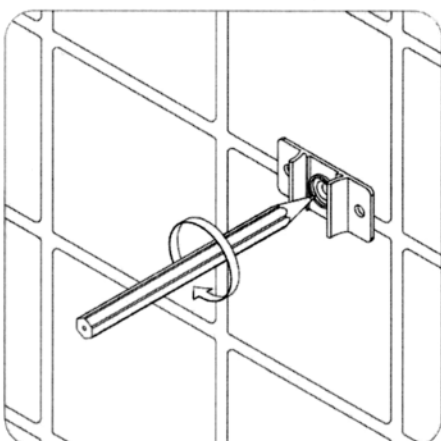

Unclip the marking plate and align with 2 points and mark the centre hole for drilling (**do not drill the outer marked points**).

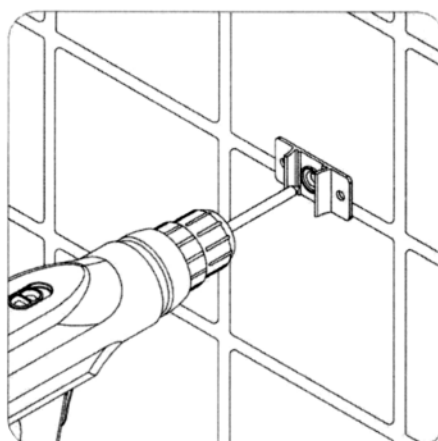

Using a suitable drill bit, **drill the marked centre hole only.**

Doors

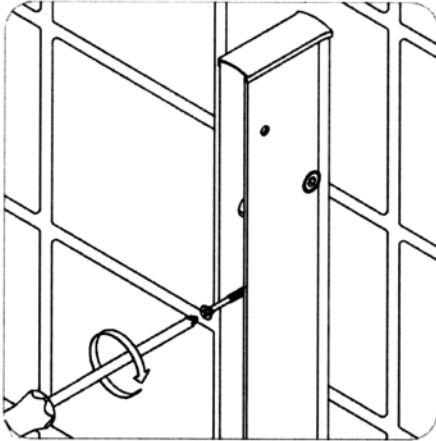

Using the appropriate screws, screw the compensator channel in place.

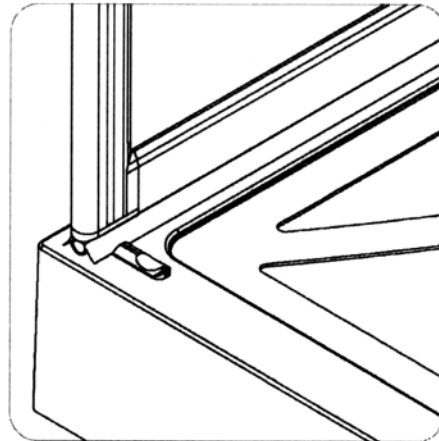

Place the 2 door setters on the tray. Insert the door into the compensator and allow the door to rest on the door setters.

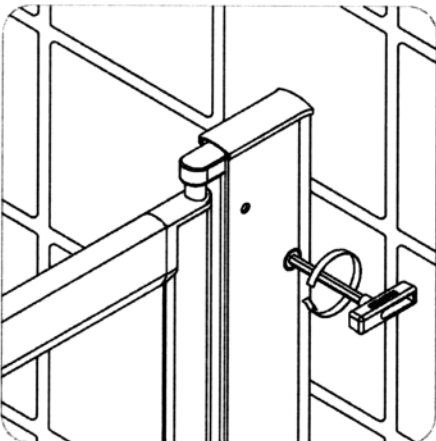

Tighten the 2 allen head screws.

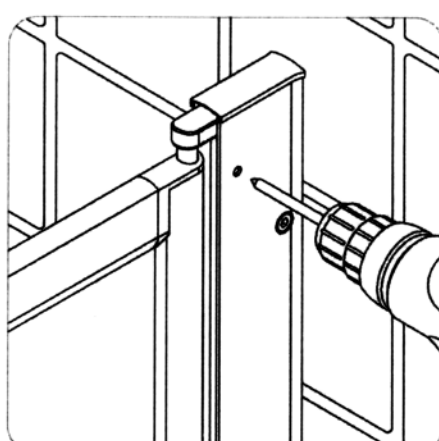

Ensure the door operation is correct then drill through the lockup holes.

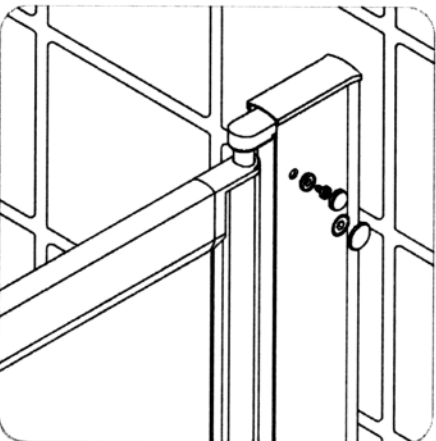

Using the screws, flange ring and domed caps lock the door into place.

Ceiling Pole

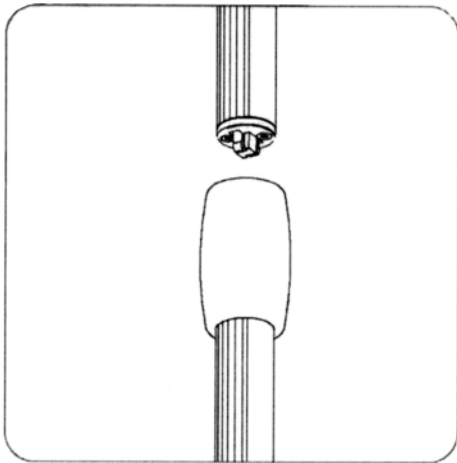

Align the fluted capping and snap the 2 pole sections together. Cut correct floor to ceiling length.

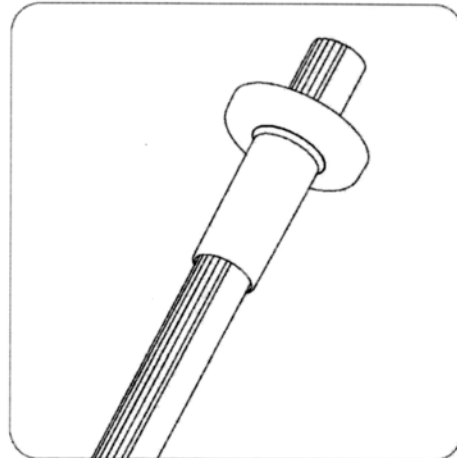

Slide the ceiling rose with cover ring onto the pole.

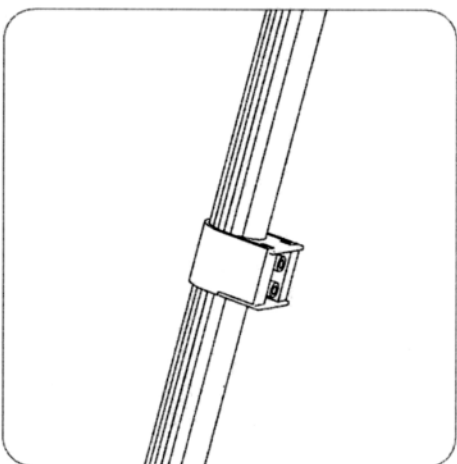

Clip the curtain rail clamp bracket onto the pole.

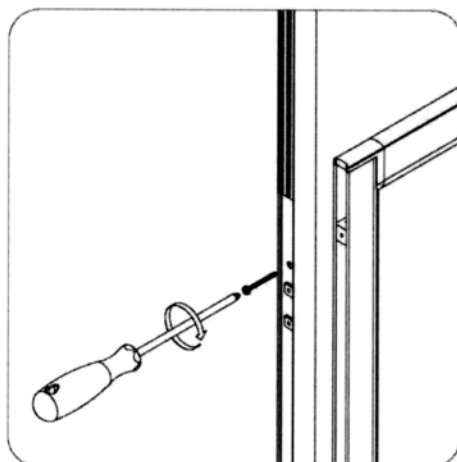

Align the floor to ceiling pole with the panel and join using the screws provided.

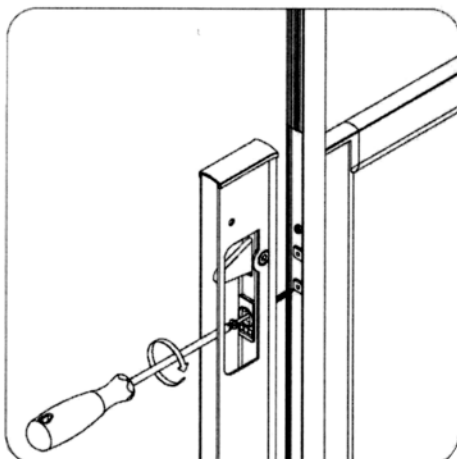
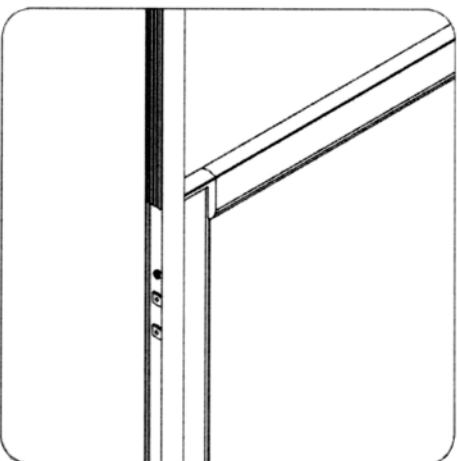

Remove the door fixing compensator from the doors and screw in position as shown in the cutaway.

Ceiling Pole

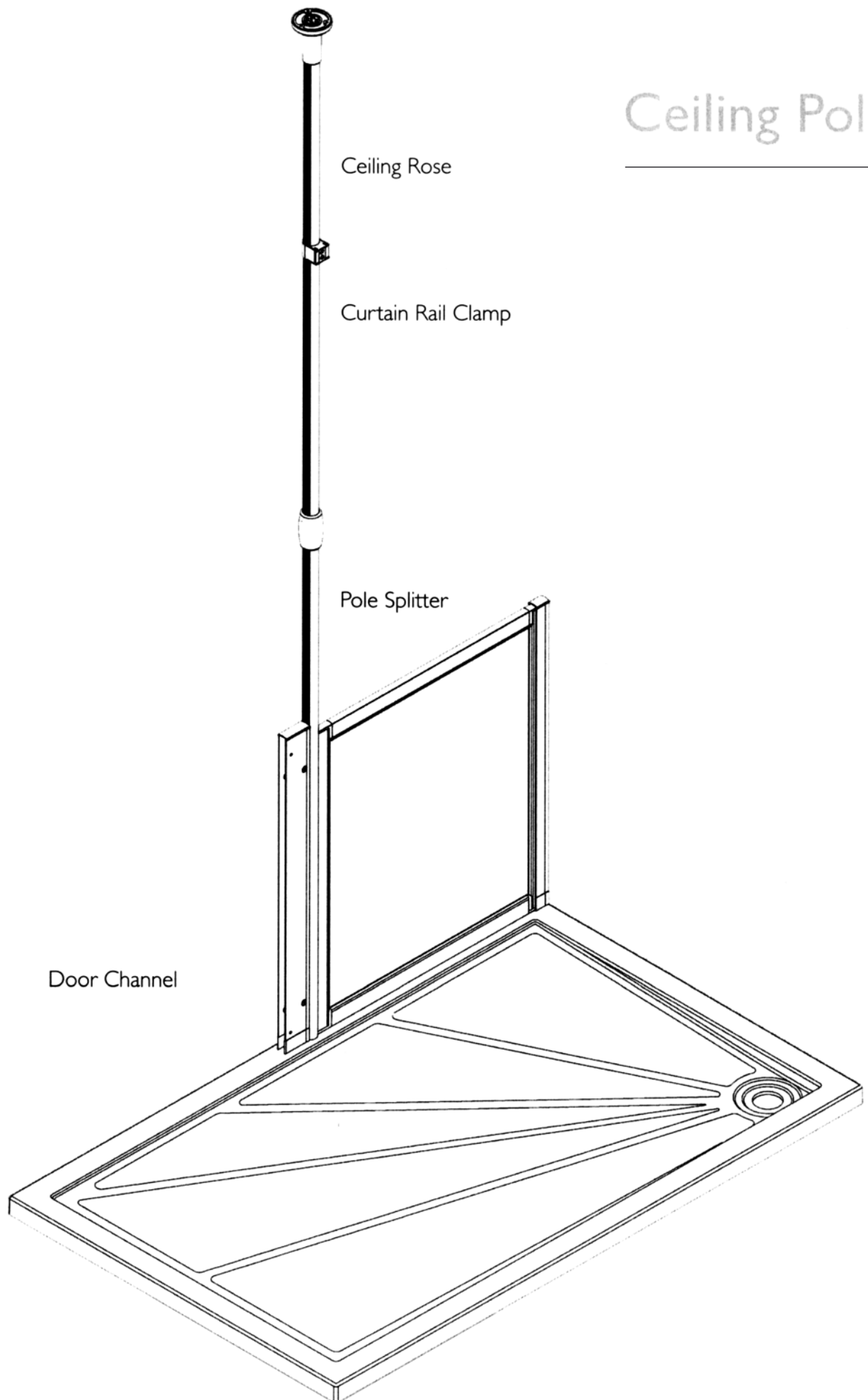



Practical Care Products Ltd

Upper Interfields
Leigh Sinton Road

Malvern

Worcestershire WR14 1UT

Tel: 01886 830119

Fax: 01886 830118

info@practicalcareproducts.com